

The Napa River/Napa Creek Flood Protection Project *Napa River Dry Bypass*

NAPA RIVER DRY BYPASS – NAPA RIVER FLOOD PROTECTION

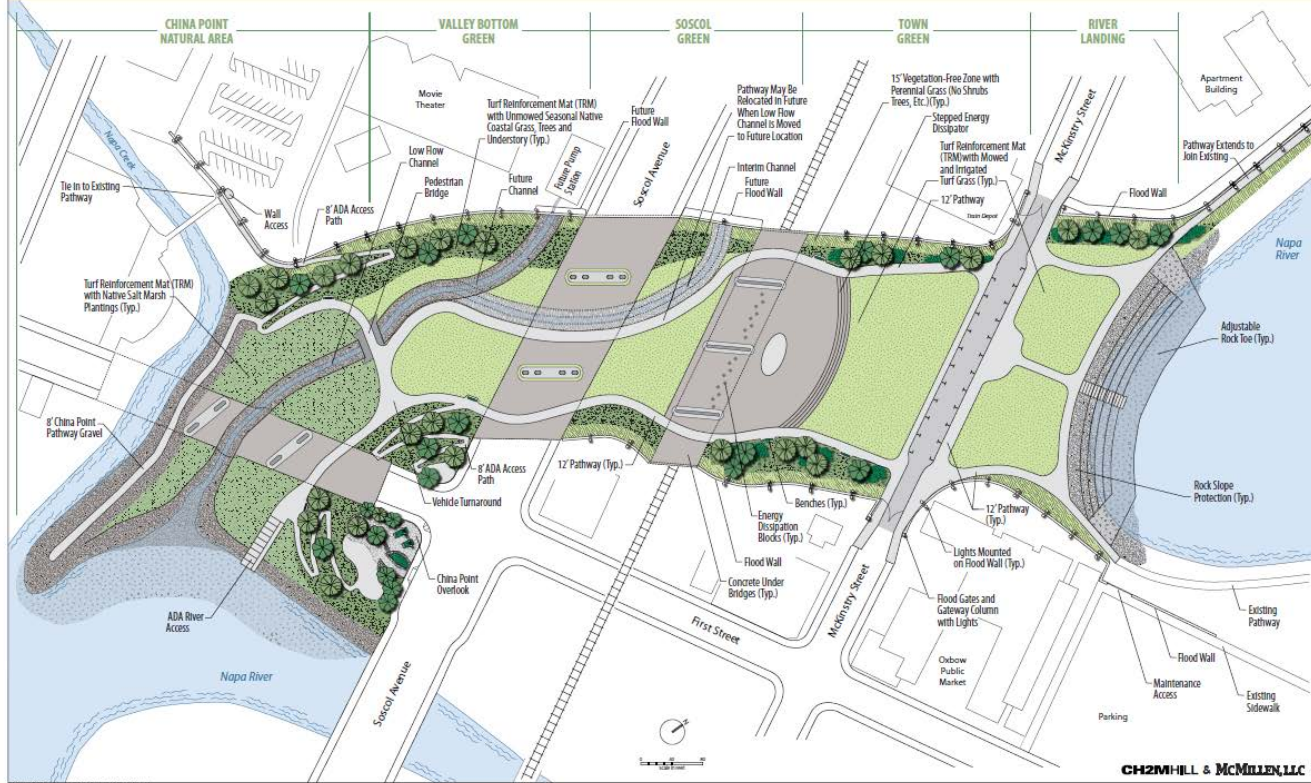

Living River Design

Downtown "Urban Reach"

South Wetlands

Toxics Cleanup

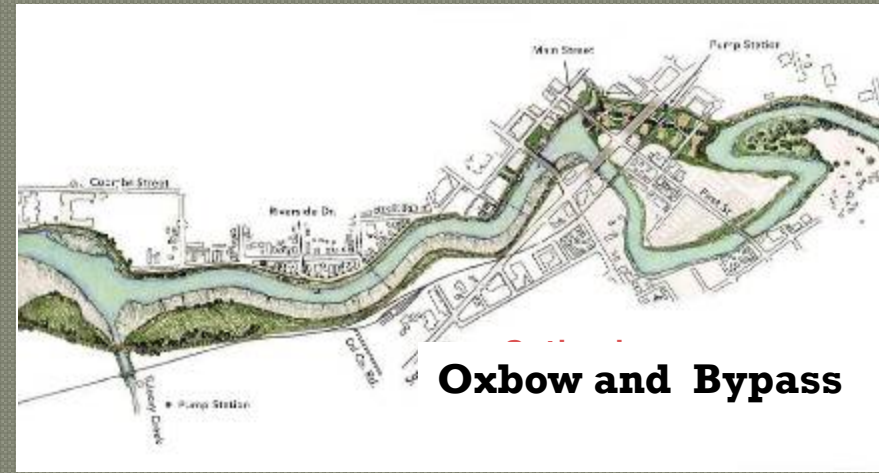
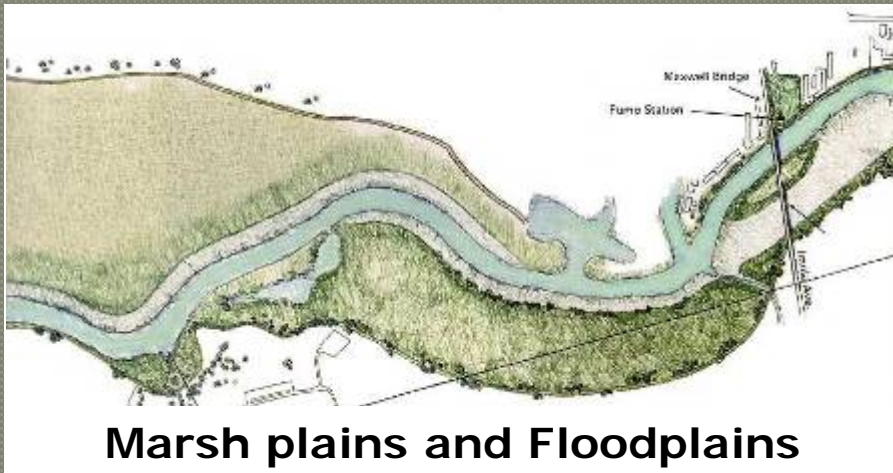

Railroad Relocation
Completed 2012

Remaining Floodwalls
2015 – Project End

Napa Creek
Completed 2013

Bypass
2014-2015

Project Component Schedule

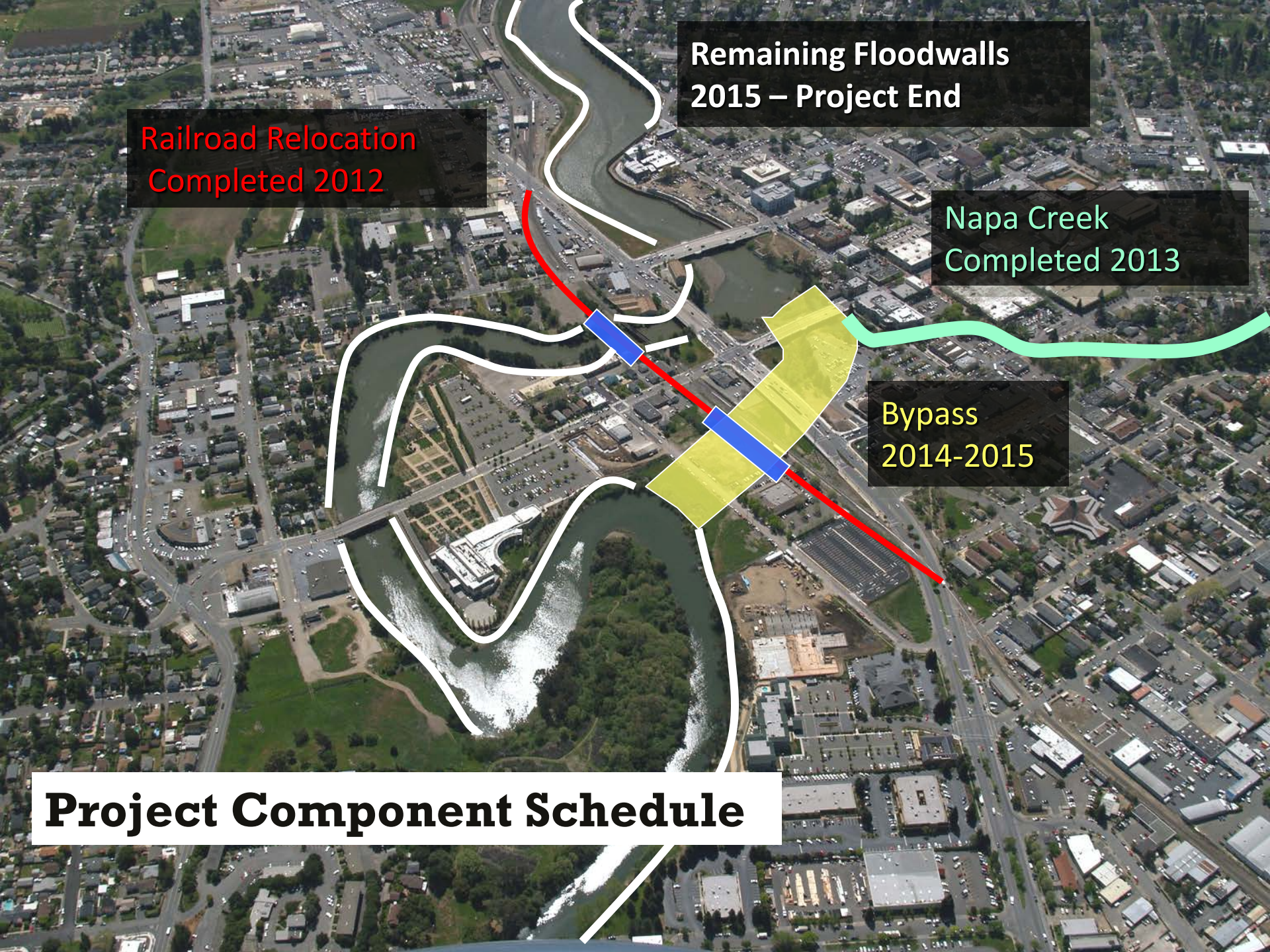

1998 Rendering



1999 Conceptual Sketch

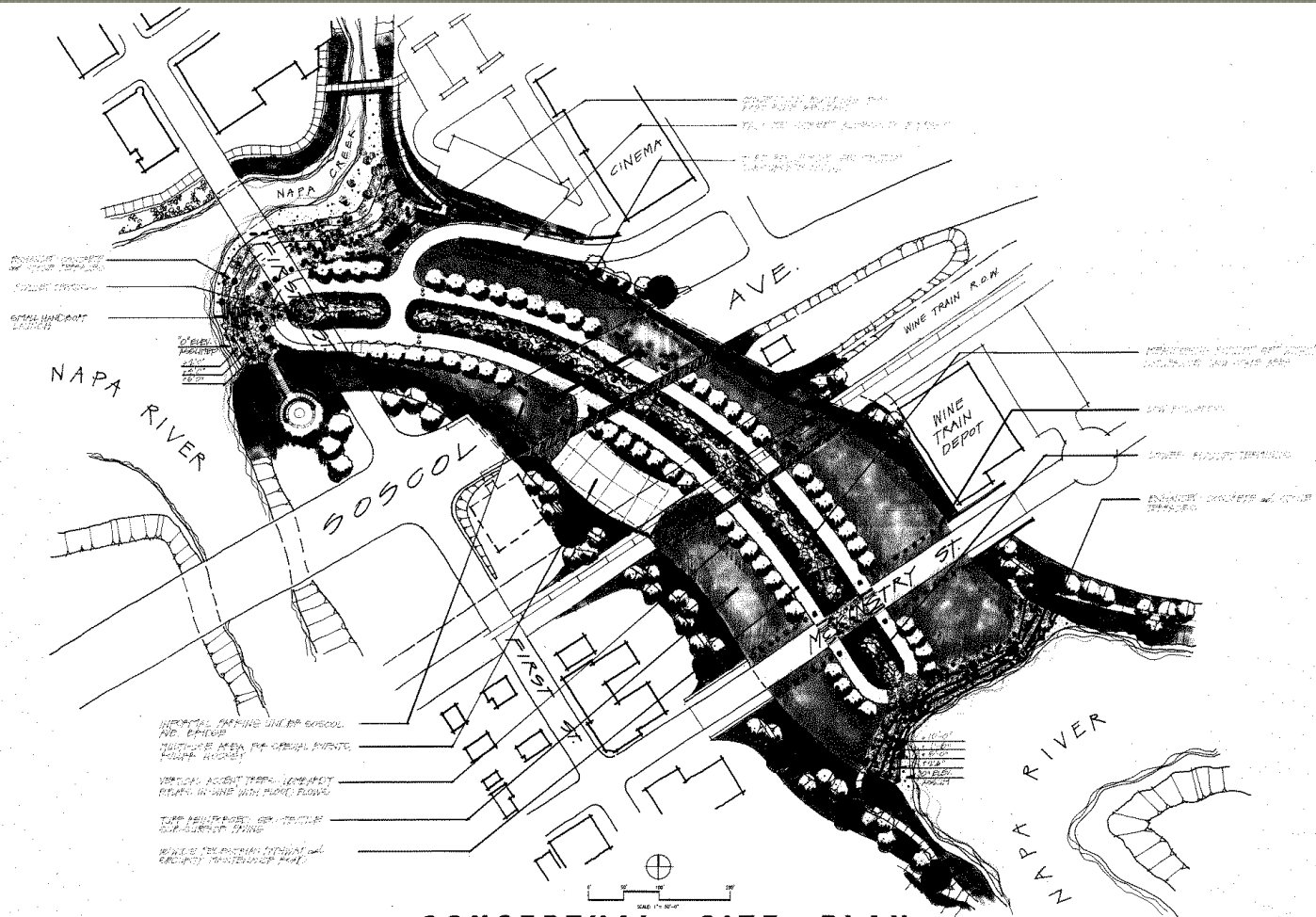

CONCEPTUAL SITE PLAN

NAPA RIVER BYPASS

Napa, California

August 25, 1999



2004 City of Napa Proposal



NAPA COMMONS
TIDAL MARSH

VALLEY BOTTOMS GREEN

SOSCOL GREEN

TOWN GREEN

RIVER LANDING

2013 Final Design

NAPA RIVER DRY BYPASS – NAPA RIVER FLOOD PROTECTION





MCKINSTRY ST

FIRST ST

SOSCOT AVE

Napa River Oxbow

Pre-project requirements



Build Railroad Bridge
Build Soscol Ave Bridge
Reconstruct First St Bridge
over Napa Creek

2003

Biotechnical Bank Stabilization

NAPA RIVER DRY BYPASS – NAPA RIVER FLOOD PROTECTION

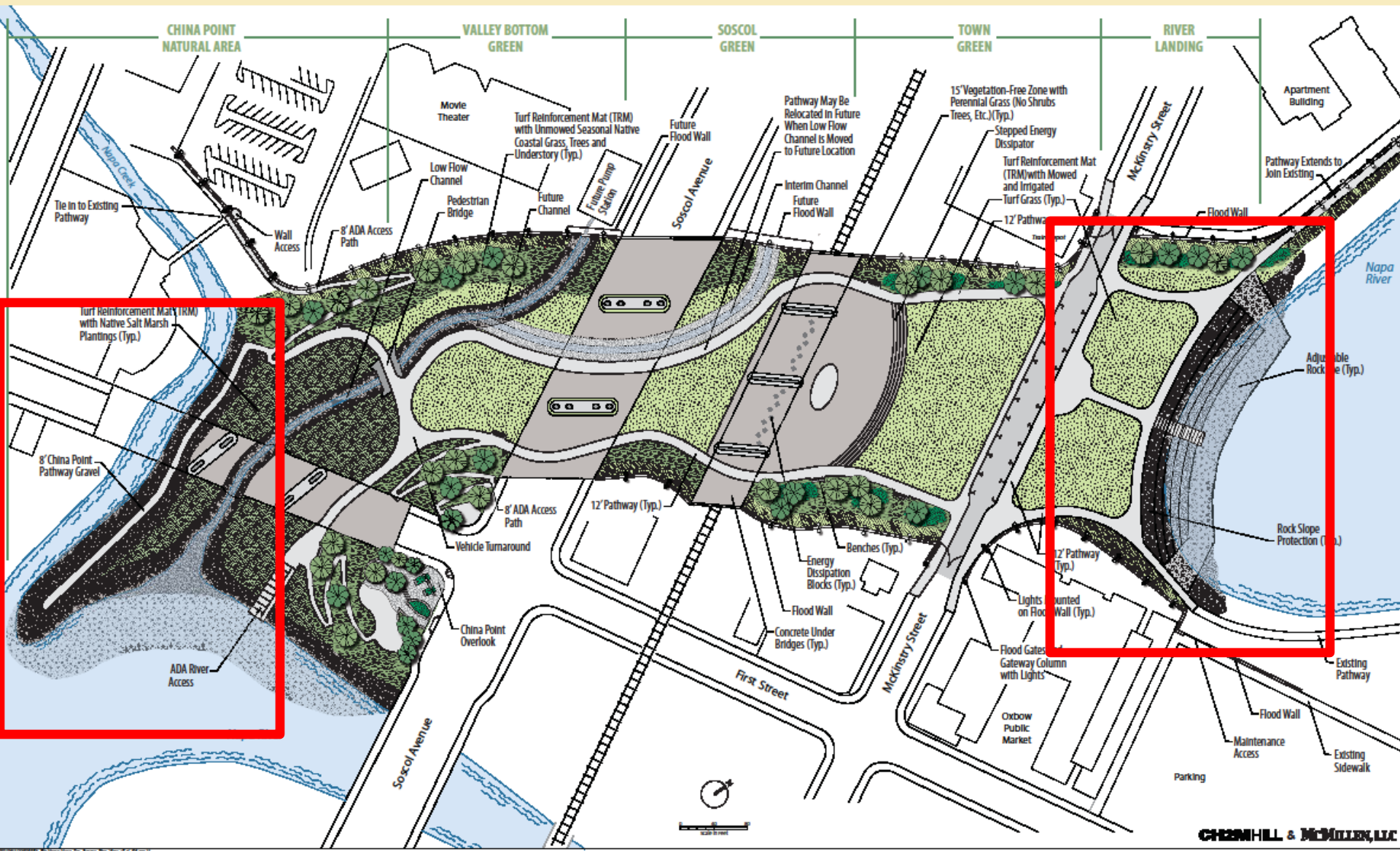





Hydraulic Energy Dissipater

NAPA RIVER DRY BYPASS – NAPA RIVER FLOOD PROTECTION

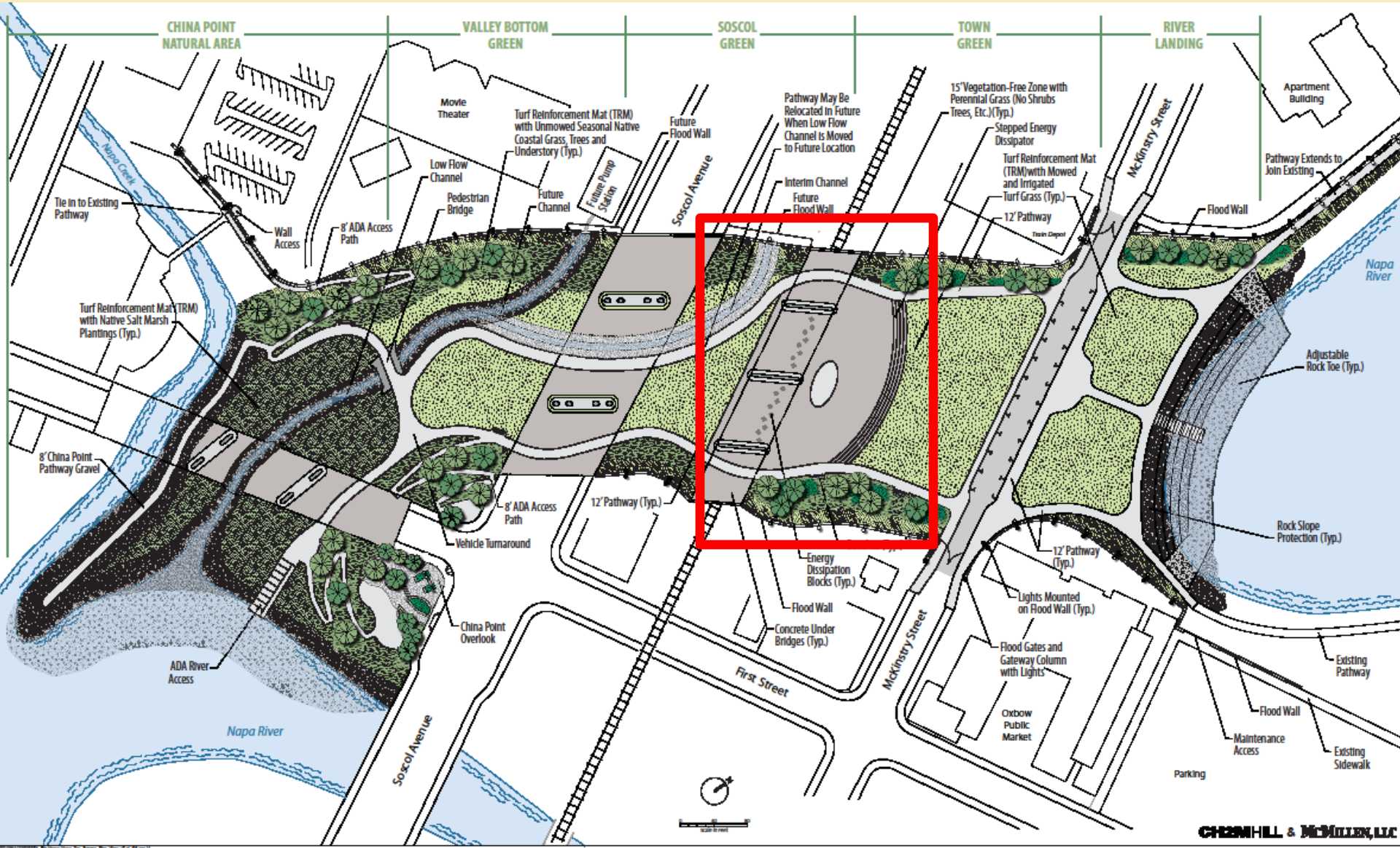

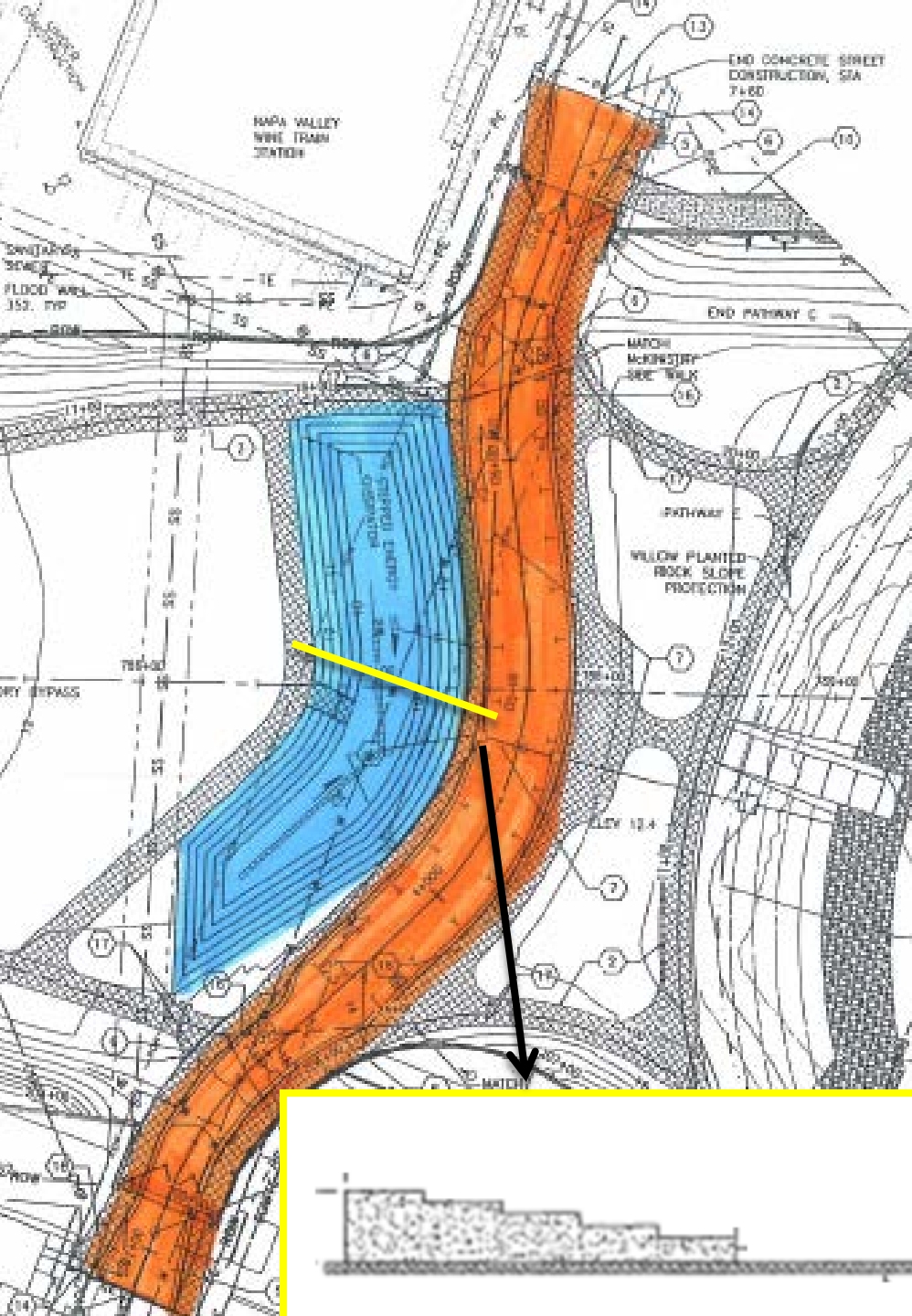

Originally Proposed Dissipater

- Required to prevent erosion in bypass channel
- Depressed concrete surface 70 feet wide
- McKinstry Street has horizontal curve
- Fish trapping and post-flood cleanup issues





Revised Dissipater

- Four 7-inch deep steps
- Each step is 4-feet in length
- McKinstry Street straightened
- Concrete surface under rail bridge extended

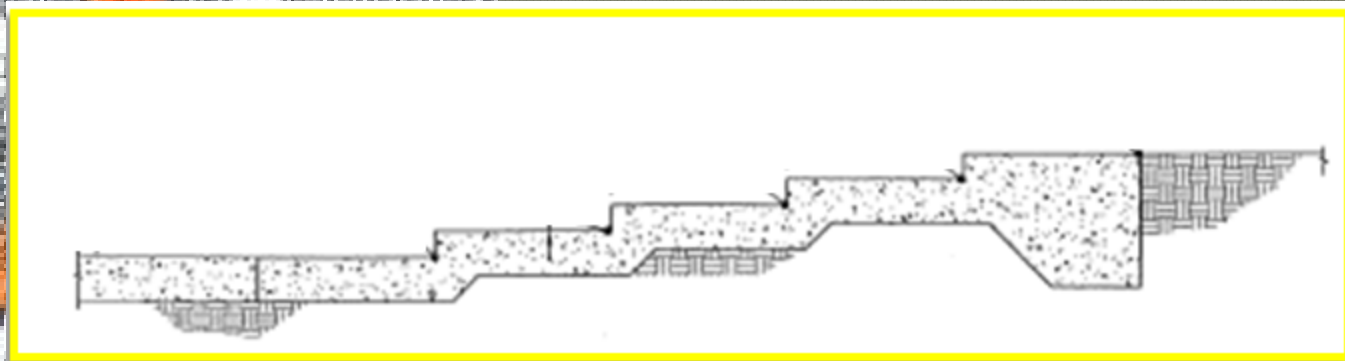

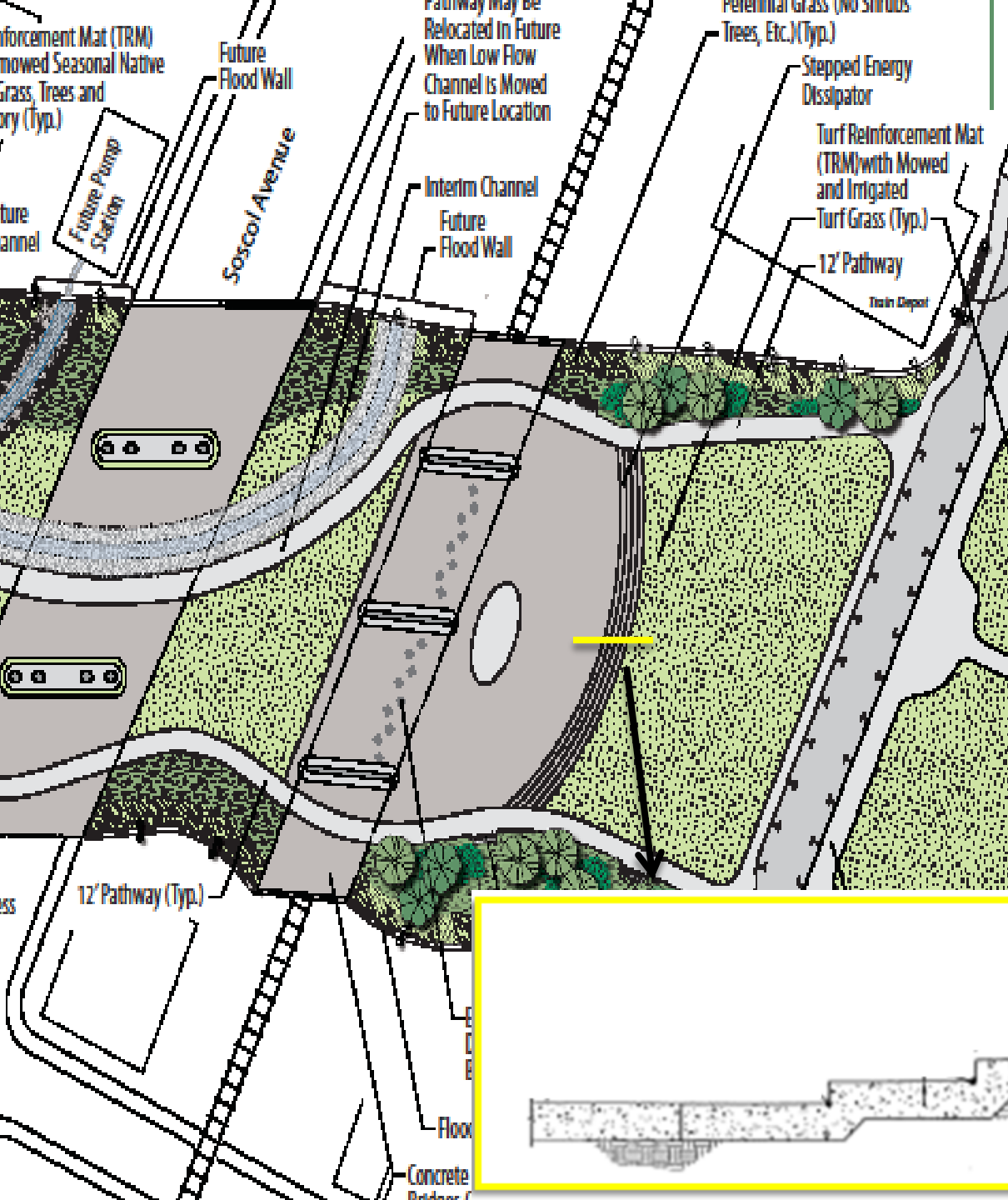

Final Dissipater

- Curved steps
- Dual use with amphitheater style design
- Dissipater block “seats” under rail bridge

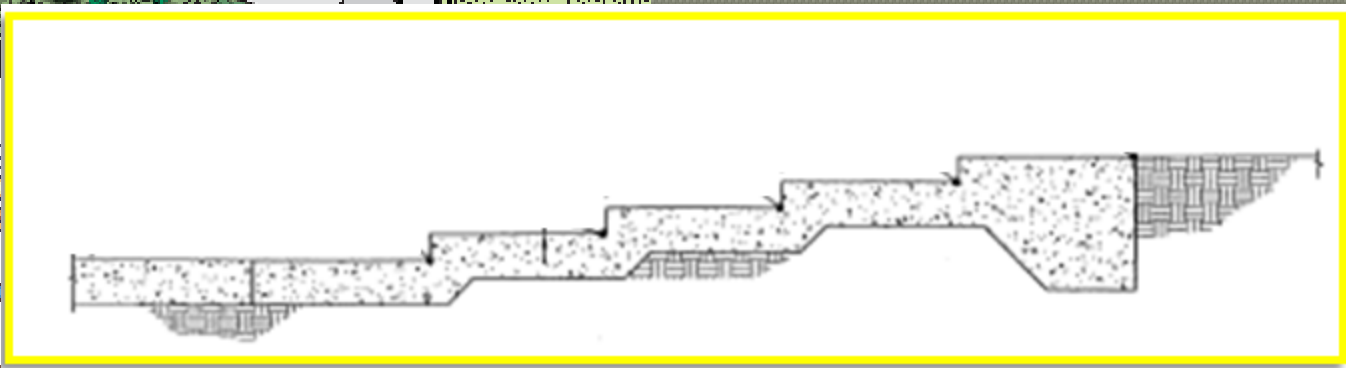

Preliminary Construction Schedule

Clearing and excavation – April to July

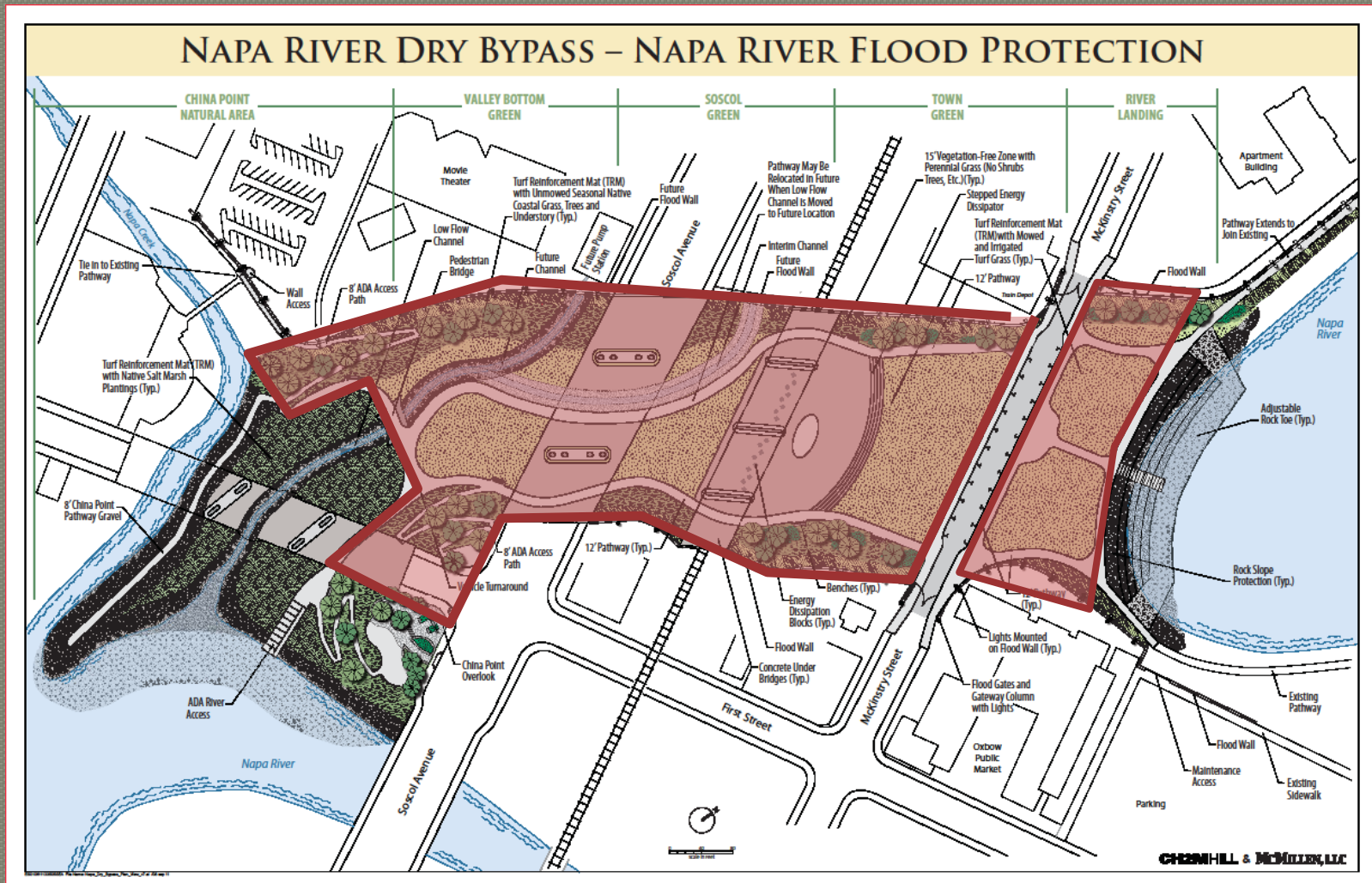

Preliminary Construction Schedule

Inlet, outlet and in-water work – June to October

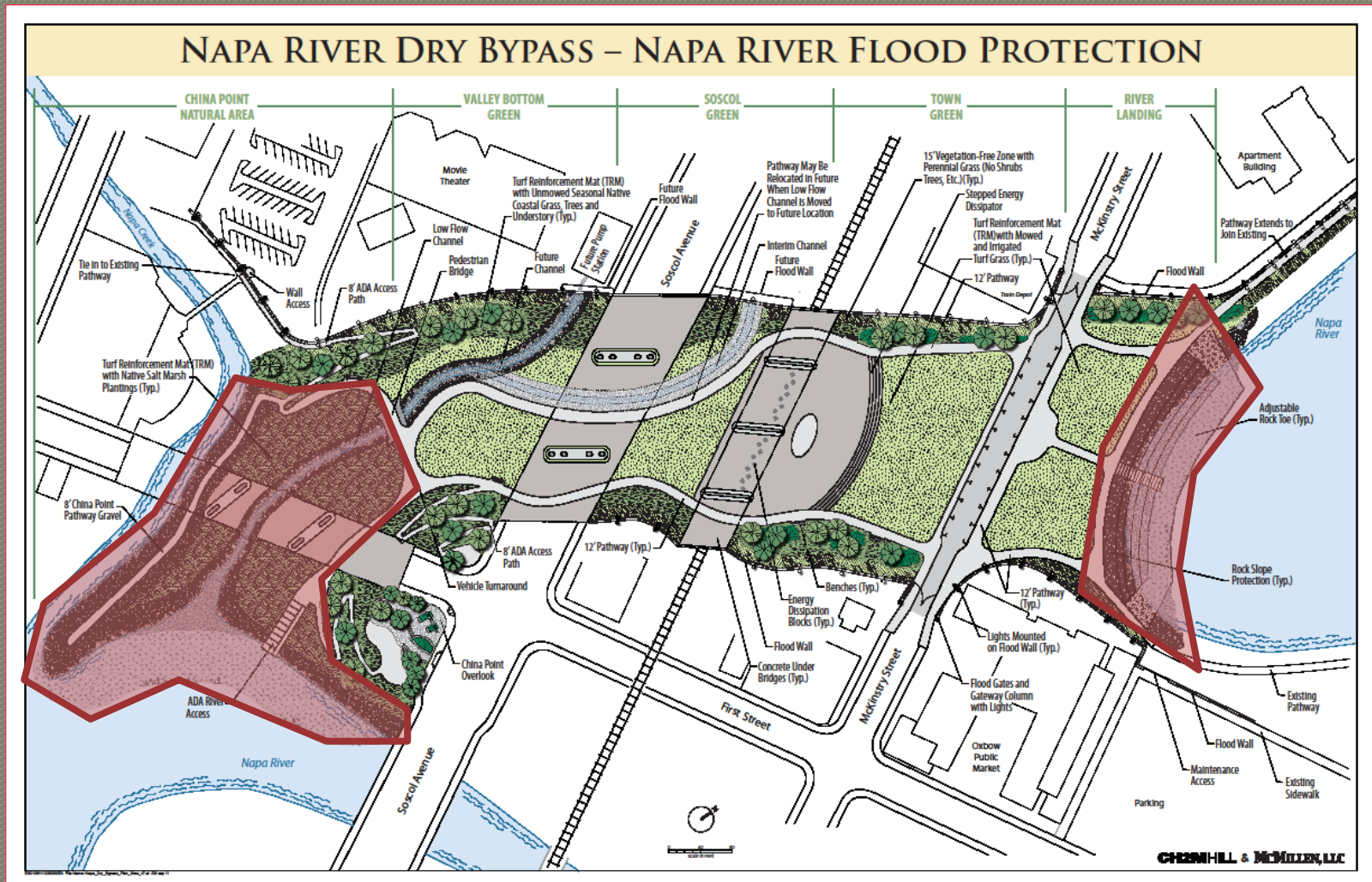

Preliminary Construction Schedule

McKinstry Street – July to August

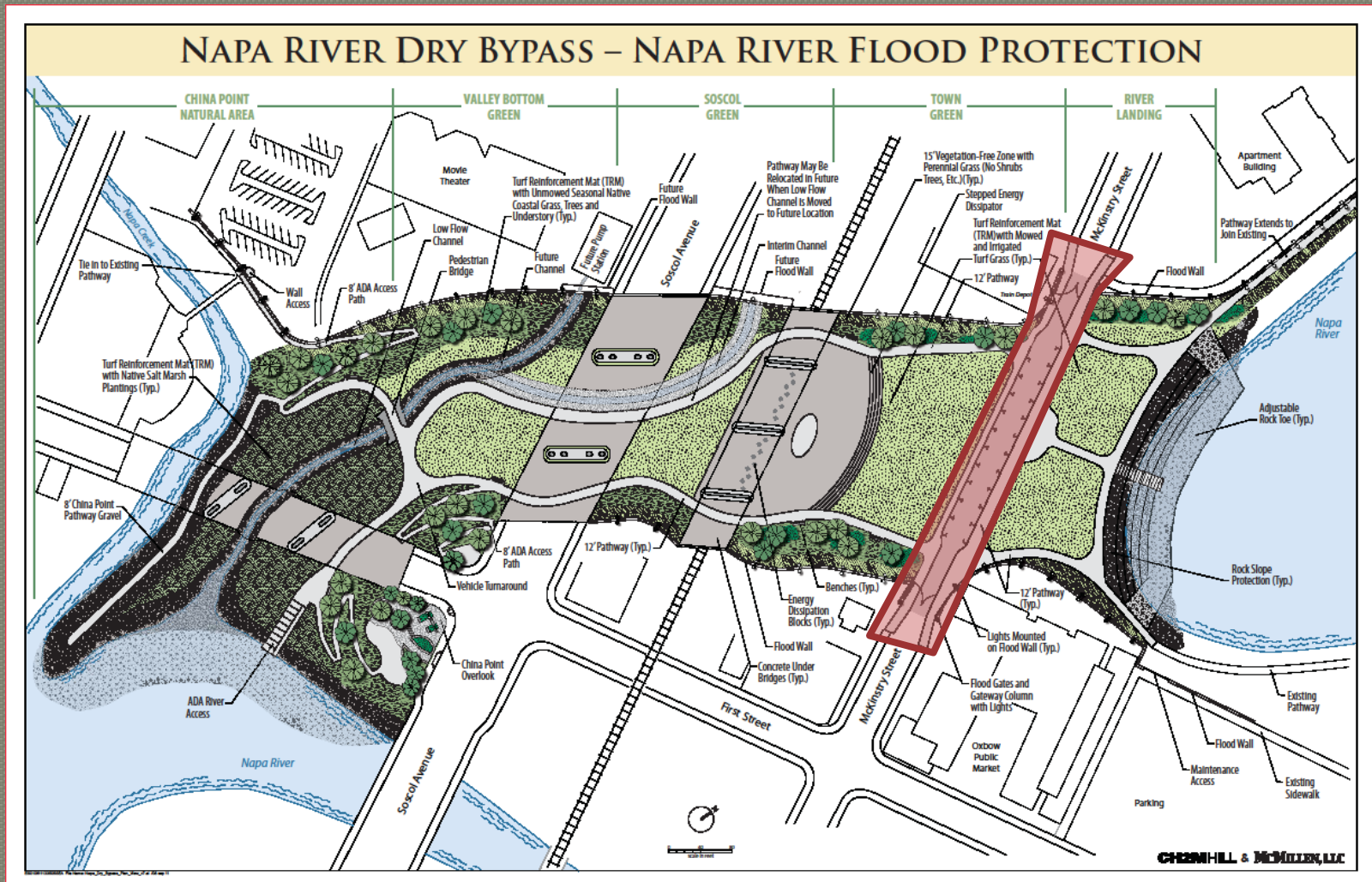

Preliminary Construction Schedule

Concrete work and planting – September to January
Projected completion: March 2015

