

NAPA COUNTY DEPARTMENT OF PUBLIC WORKS

NAPA RIVER RUTHERFORD REACH RESTORATION PROJECT - REACHES 1 & 2 EAST BANK PW 09-01

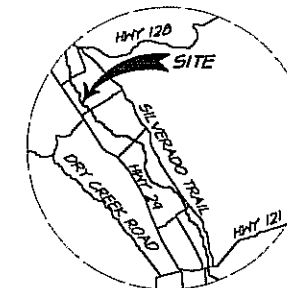

VICINITY MAP
NOT TO SCALE

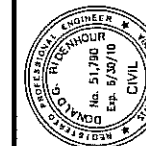

DATE

DONALD G. RIDEHOUR, P.E.
COUNTY ENGINEER, R.C.E. 51790

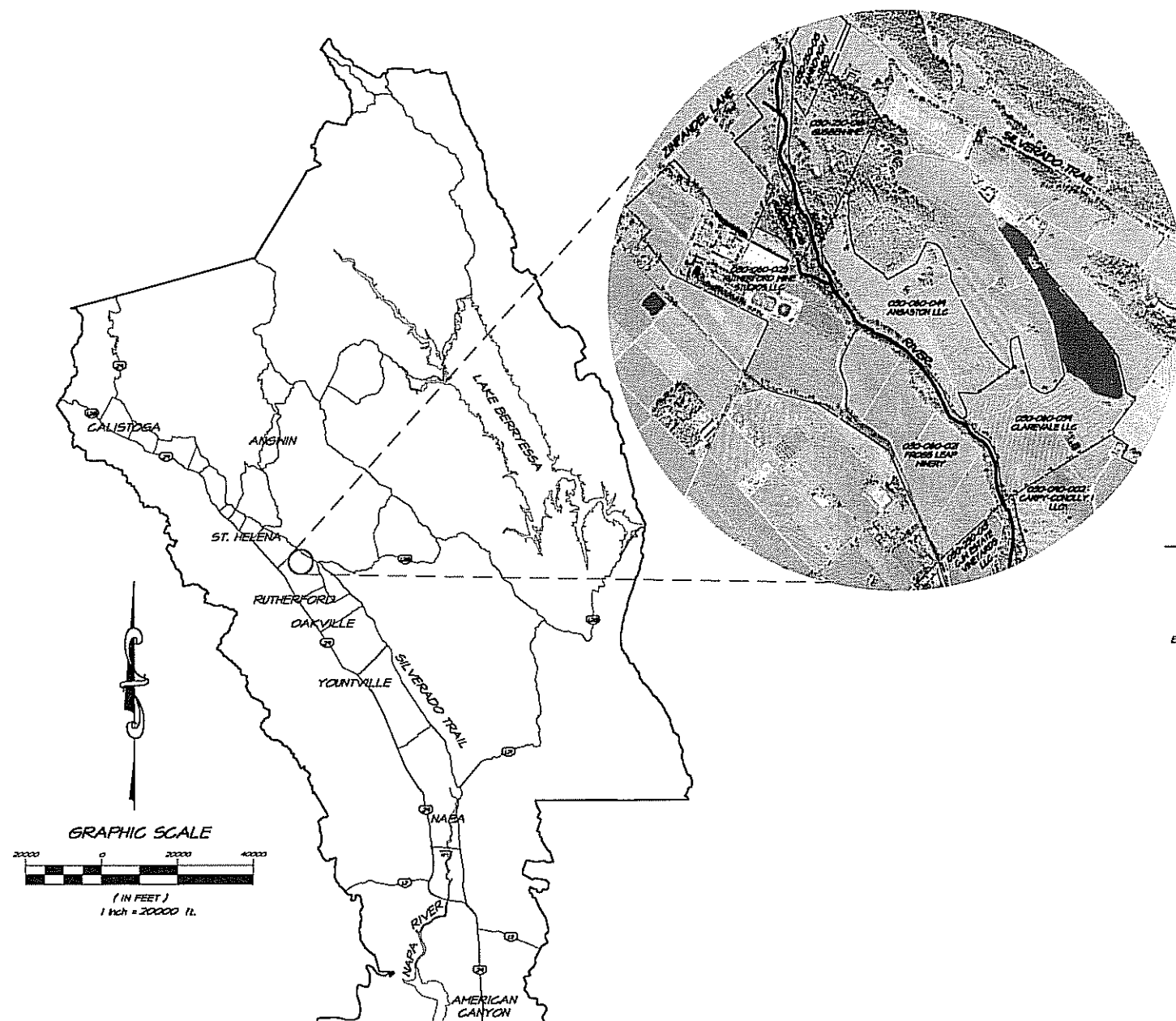

GENERAL NOTES

ENVIRONMENT, LAND, WATER AND ECOLOGY CONSULTING FIRM:	ICF JONES & STOKES 2541 JUNCTION AVE, SUITE 114 SAN JOSE, CA 95134 (707) 468-134-2344
ECOLOGICAL RESTORATION SERVICES:	FRUNKE CHATHAM, INC. 400 MORRIS STREET, SUITE 6 SEASIDE, CA 95712 (707) 824-1602B
WATER RESOURCES:	NORTHWEST HYDRAULIC CONSULTANTS 3500 INDUSTRIAL BLVD, 1002C WEST SACRAMENTO, CA 95691 (916) 371-7400
CIVIL ENGINEER:	RECHERS SPENCE AND ASSOCIATES 1541 THIRD STREET NAPA, CA 95959 (707) 252-3304
GEOTECHNICAL ENGINEER:	MILLER PACIFIC ENGINEERING GROUP 135 CAMINO DORADO, SUITE 3 NAPA, CA 94950 (707) 263-7836
SURVEYOR:	DOBLE THOMAS 134 SOUTH CLOVERDALE BLVD. CLOVERDALE, CA 95425 (707) 836-4740

SYMBOL LEGEND

EXISTING	PROPOSED	
EX. E	---	EDGE OF PAVEMENT
FLOWLINE	---	FLOWLINE
EX. SANITARY SEWER PIPE	---X" SS	SLOPE INDICATOR
EX. STORM DRAIN PIPE	---X" SD	PROPERTY BOUNDARIES
EX. WATER LINE	---B" W	
EX. TREE TO REMAIN	(O)	
CONTOUR LINE SPOT	235	
ELEVATION	235.2	

ABBREVIATIONS

APPROX	APPROXIMATE
CL	CENTERSLINE
EG	EXISTING GROUND
EX	EXISTING
FG	FINISHED GROUND
FL	FLOWLINE
TOB	TOP OF BANK
TOS	TOP OF SLOPE
TYP	TYPICAL

NOTES

1. A SEPARATE STANDARD SPECIFICATIONS DOCUMENT ACCOMPANIES THIS SET OF PLANS.
2. THE CONTRACTOR IS RESPONSIBLE FOR COMPLYING WITH ALL PERMIT CONDITIONS ESTABLISHED BY U.S. FISH AND WILDLIFE SERVICE, CALIFORNIA DEPARTMENT OF FISH AND GAME, U.S. ARMY CORPS OF ENGINEERS, AND NOAA FISHERIES.
3. CONSTRUCTION, EXCEPTING PLANTING, IS TO BE CONDUCTED BETWEEN LINE 15 AND JULY 15, 2009.

SHEET INDEX

COVER SHEET	1
SURVEY CONTROL	2
SHEET KEY PLAN	3
STAGING & ACCESS PLAN	4
GRADING PLANS	5 TO 12
CROSS SECTIONS	13
ROAD PROFILES	14
PLANTING PROGRAM	15
PLANTING & IRRIGATION PLANS	16 TO 23
DETAILS SHEET	24
DETAILS SHEET	25
PLANTING DETAILS	26
IRRIGATION DETAILS	27

COVER SHEET
NAPA RIVER RUTHERFORD REACH RESTORATION PROJECT - REACHES 1 & 2
EAST BANK
SHEET 1 OF 27

DATE	APRIL 22, 2009
SCALE	NONE
FILE NAME	NONE
DESIGN	JPS
DRINK	LLH
CHND	FGA

SURVEY NOTE
NAPA COUNTY
DEPARTMENT OF PUBLIC WORKS
1105 THIRD STREET, ROOM 201
NAPA, CALIFORNIA 94950-1052
PHONE 707-253-4351 • FAX 707-253-4827
DONALD G. RIDEHOUR
County Engineer, Road Commissioner

NAPA COUNTY
DEPARTMENT OF PUBLIC WORKS
1105 THIRD STREET • ROOM 201
NAPA, CALIFORNIA 94950-1052
PHONE 707-253-4351 • FAX 707-253-4827
DONALD G. RIDEHOUR
Acting-Director of Public Works, County
County Engineer, Road Commissioner

ICF Jones & Stokes
an ST International Company

FRUNKE CHATHAM, INC.
400 MORRIS STREET, SUITE 6
SEASIDE, CA 95712
(707) 824-1600

nhc
northwest hydraulic consultants inc.
3550 INDUSTRIAL BOULEVARD, SUITE 100C
WEST SACRAMENTO, CALIFORNIA 95691
PHONE (916) 371-7400
FAX (916) 371-7475 www.nhcweb.com

RECHERS SPENCE AND ASSOCIATES
1541 THIRD STREET
NAPA, CALIFORNIA 95959
TEL (707) 252-3304 FAX (707) 252-3308



PREPARED UNDER THE DIRECTION OF:
FRANCIS G. ADRIAS, R.C.E. 68738, Exp. 09.30.2009

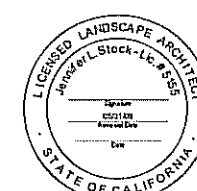

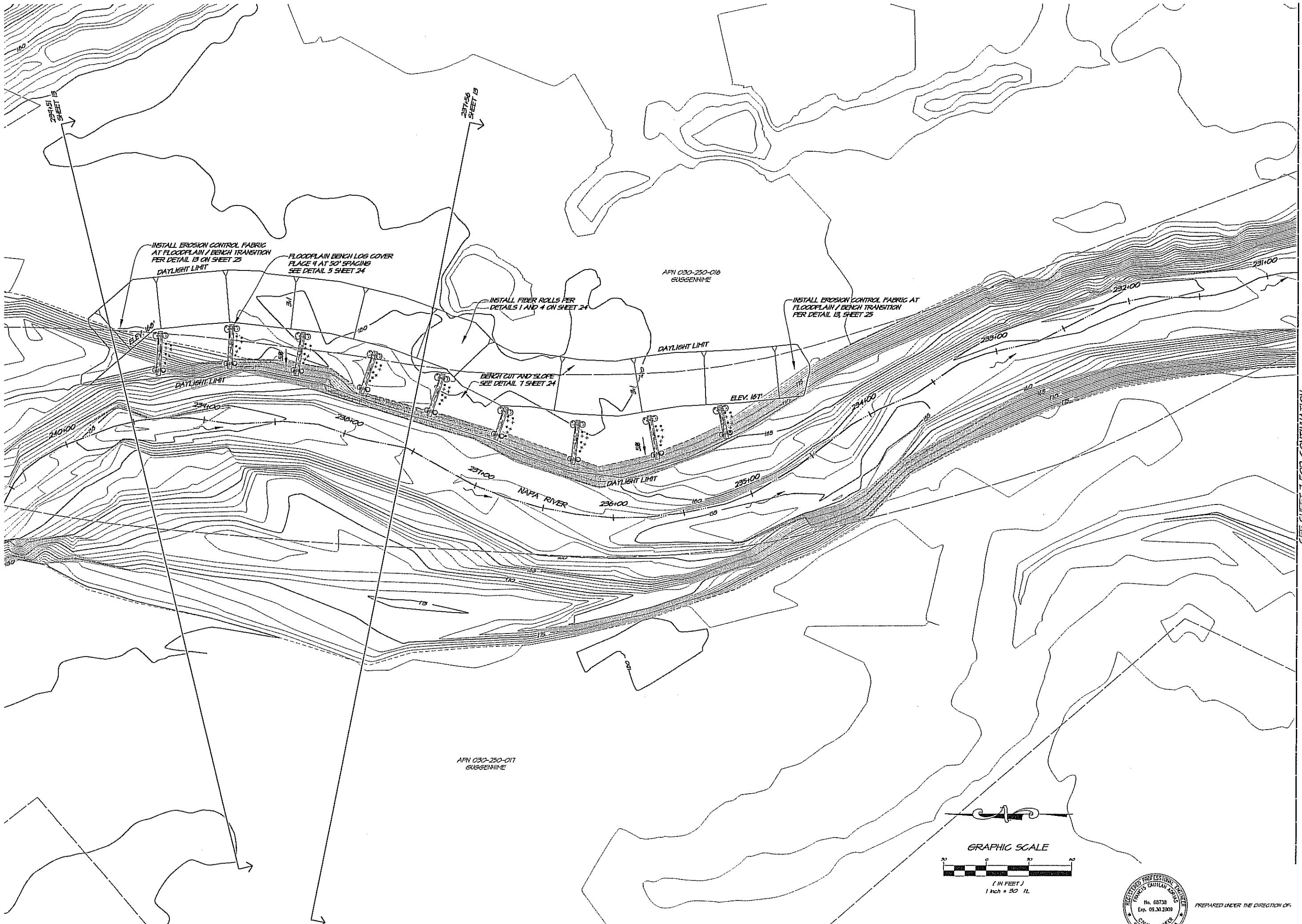

28151
SHEET B

28156
SHEET B

INSTALL EROSION CONTROL FABRIC
AT FLOODPLAIN / BENCH TRANSITION
PER DETAIL B ON SHEET 25
DAYLIGHT LIMIT

FLOODPLAIN BENCH LOS COVER
PLAGE 9 AT 50' SPACING
SEE DETAIL 5 SHEET 24

INSTALL FIBER ROLLS PER
DETAILS 1 AND 4 ON SHEET 24

INSTALL EROSION CONTROL FABRIC AT
FLOODPLAIN / BENCH TRANSITION
PER DETAIL B, SHEET 25

BENCH CUT AND SLOPE
SEE DETAIL 7 SHEET 24

APN 030-250-016
GUSSENHME

APN 030-250-017
GUSSENHME

NAPA RIVER

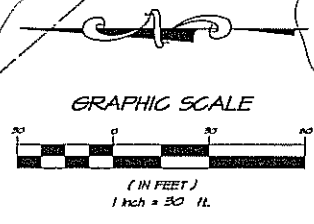

PREPARED UNDER THE DIRECTION OF:

SEE SHEET 7 FOR CONTINUATION

NAPA RIVER RESTORATION PROJECT - RUTHERFORD REACH
GRADING PLAN
EAST BANK

DATE	APRIL 22, 2009
DRAWN	LLM
DESIGNED	DS
CHECKED	PCA
JOB NO.	51620220
SHEET NO.	5



1541 Third Street
Pasadena, California 91105

T 707.252.3301
F 707.252.4066

\\s0200220_Rutherford_Reach\dwg\2009\03-04 east site\06 - GRADING PLAN.dwg 04/22/2009 2:51:28PM J:\spencer COPYRIGHT Riechers Spence & Assoc.

NO.	DATE	REVISIONS	BY

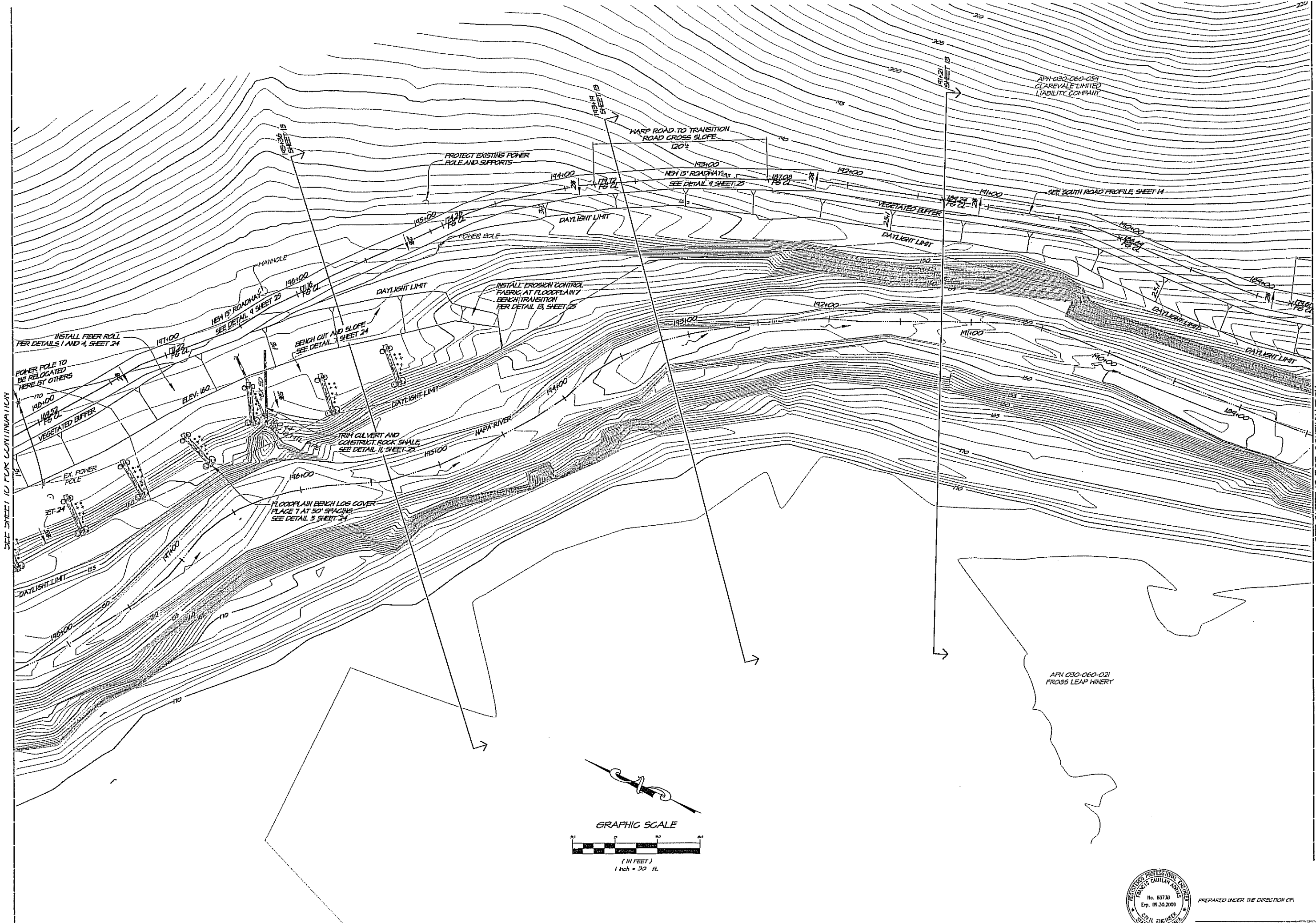

SEE SHEET 10 FOR CONTINUATION

SEE SHEET 12 FOR CONTINUATION

APN 030-060-054
CLAREVALE LIMITED
LIABILITY COMPANY

APN 030-060-021
FROSS LEAP WINERY

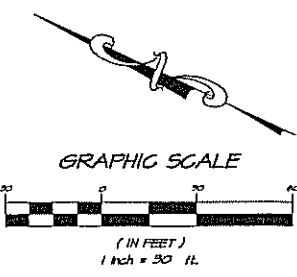

NAPA RIVER RESTORATION PROJECT - RUTHERFORD REACH
GRADING PLAN
EAST BANK

DATE	APRIL 22, 2007
DRAWN	LLM
DESIGNED	JDS
CHECKED	FLA
JOB NO.	56200220
SHEET NO.	11



PREPARED UNDER THE DIRECTION OF:
FRANCIS CAUTLAN ADAMS
REGISTERED PROFESSIONAL ENGINEER
No. 60730
Exp. 09.30.2009
CIVIL ENGINEER

REVISIONS
DATE
NO.
BY
707.252.3301
707.252.4966
1541 Third Street
Healdsburg, California 94539
Copyright © 2007 RITCHERS ENGINEERS ASSOCIATES
04/22/2007 11:55:54 AM
C:\PROJECTS\NAPA_RIVER\GRADING\PLAN\GRADING_PLAN_EAST_BANK.dwg

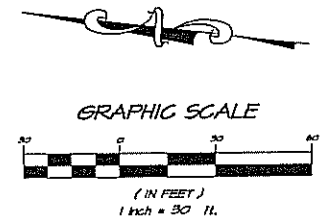
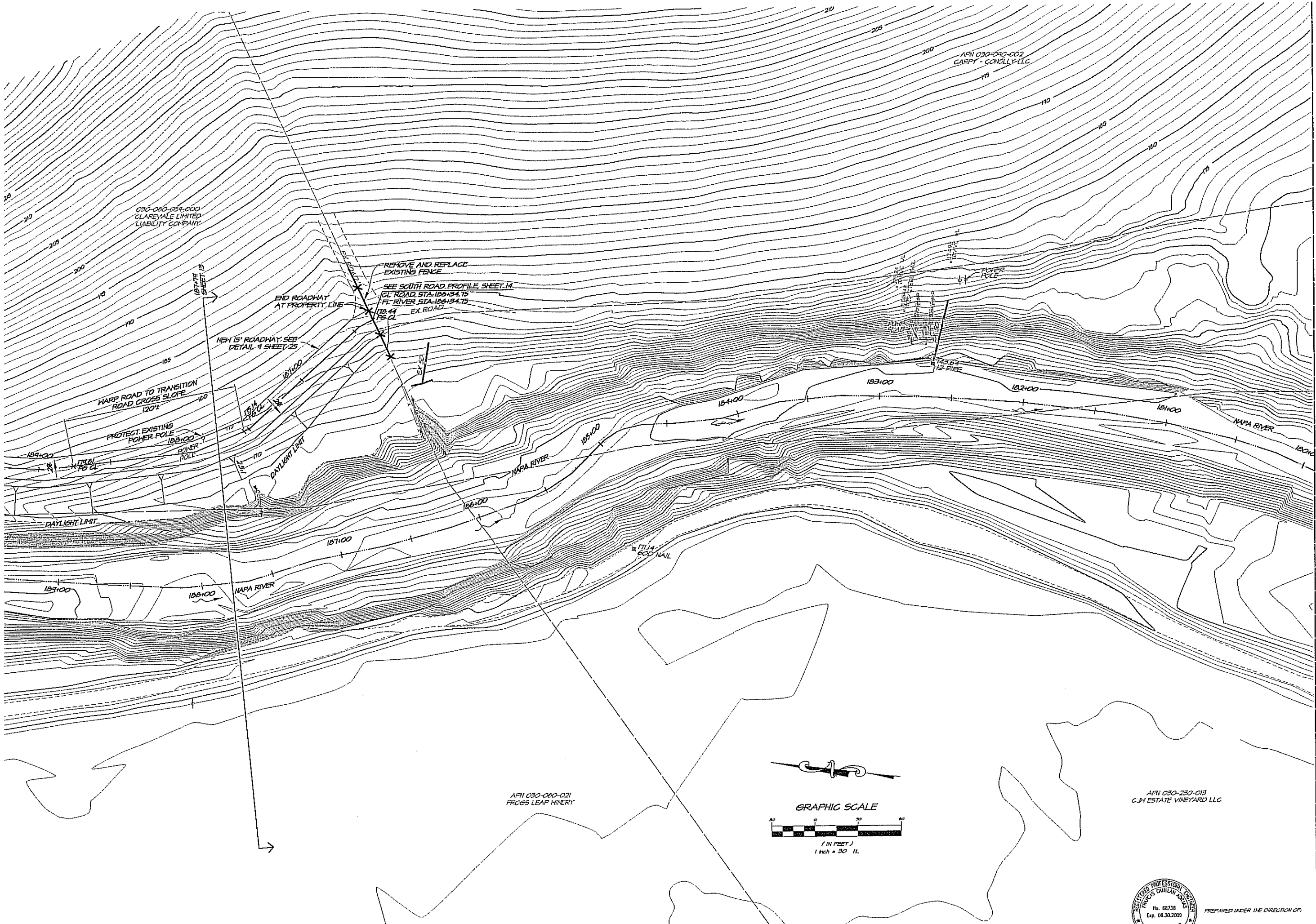

END OF PHASE 1A



NAPA RIVER RESTORATION PROJECT - RUTHERFORD REACH
GRADING PLAN
 EAST BANK

DATE	APRIL 22 2009
DRAWN	LLM
DESIGNED	JDS
CHECKED	PCA
JOB NO.	518800270
SHEET NO.	12



PREPARED UNDER THE DIRECTION OF:
 FRANCIS C. ADAMS, P.E. A0119 EXP. 09.30.2009

2010/06/02/00_Rutherford_Restoration/03-04-east_bank/12/11/09 - GRADING PLAN - EAST BANK - RUTHERFORD REACH - NAPA RIVER RESTORATION PROJECT
 1541 Third Street
 Napa, California 94959
 Y 707.252.1301
 F 707.252.4966